

# FSX

## GT-300W-V3

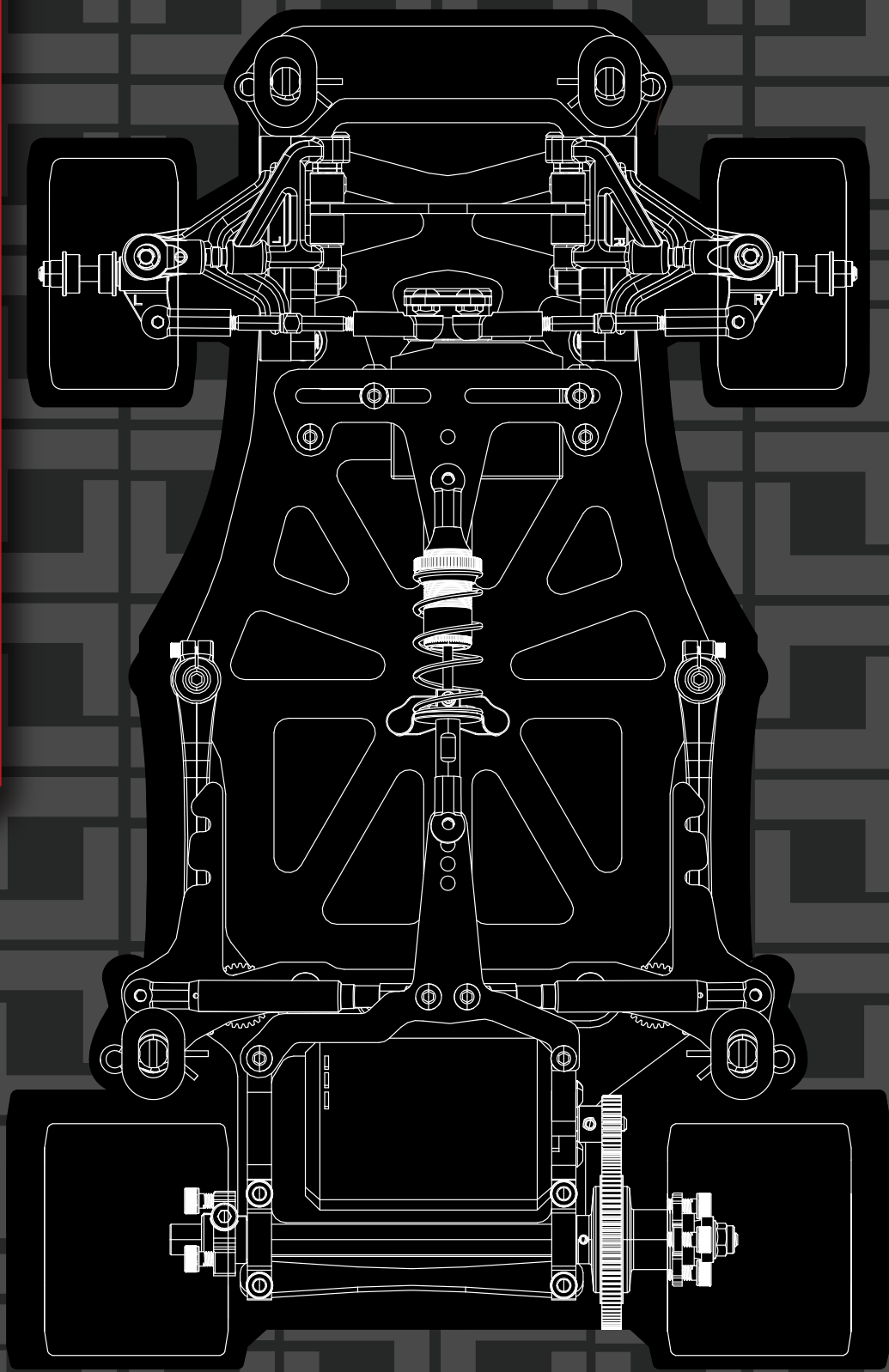

Thank you for purchasing this TEAMSAXO product. This high performance competition kit has been proudly manufactured by TEAMSAXO World Champion R/C car manufacturer.  
Proper assembly of this product will provide fun, safe enjoyment.

## PRECAUTIONS FOR SAFE ENJOYMENT OF YOUR R/C CAR

For children under the age of 13, parental guidance is recommended when running.

### ASSEMBLY PRECAUTIONS

Do not assemble around small children. The parts can be dangerous if accidentally swallowed.

Check the contents carefully before assembly. Please contact Customer Support if you happen to notice any defective or missing items.

You will find the assembly process much easier by carefully reading through the manual, and familiarizing yourself with the instructions.

Many different tools are required during assembly. For safety purposes, please use suitable tools. Exercise extra caution when using a sharp tool such as a hobby knife.

Many different materials are used for the parts. Use extra care when handling parts with sharp edges, such as machined metal parts.

When cutting plastic parts, watch for any flying parts.

Try to assemble any rotating parts of drivetrain parts as smooth as possible.

Bundle wires neatly away from the ground or any moving drivetrain components. Make sure that all wires are properly connected to prevent shorting.

Unnecessary modifications may be unsafe and hinder performance.

Always paint in a well ventilated area away from flames.

### PRECAUTIONS BEFORE RUNNING

Teamsaxo R/C cars are built for competition use, and some models may exceed speeds of 40km per hour. Practice common sense and run the car in open safe places, or R/C car tracks.

Do not run the car on public roads with high amounts of traffic, or in areas that may cause an inconvenience to people in that area.

R/C cars are controlled using radio frequency. In a worst-case scenario, radio interferences may cause loss of control.

If others near you are running R/C cars, confirm that they are not running on the same frequency.

R/C cars do not like water. Avoid running on rainy days, or areas with water puddles. Exposure of the electronics to water may cause loss of control or damage to the electronics.

The drivetrain of an R/C car consists of many moving parts like gears, belts, shafts, and tires. Avoid touching these areas when the battery is connected.

Many parts of an R/C car will become hot after running. Allow the parts to sufficiently cool before conducting any maintenance.

### BEGINNING A RUN

1. Place the R/C car on a stand so the wheels are off the ground.
2. Confirm that the speed controller switch is OFF, and connect the motor and battery.
3. Extend the transmitter antenna and turn the switch ON. (It is unsafe to use a transmitter with low voltage. Make sure that the transmitter batteries are good before running.)
4. Turn the speed controller switch ON.

### FINISHING A RUN

1. Turn the speed controller switch OFF.
2. Disconnect the battery.
3. Turn the transmitter switch OFF, and retract the antenna.

## ASSEMBLING TOOLS REQUIRED (NOT INCLUDED IN KIT)

### Scissors

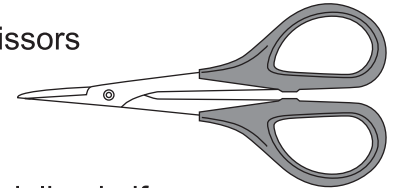

### Modeling knife

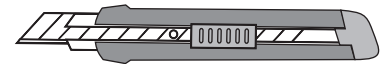

### Side cutters

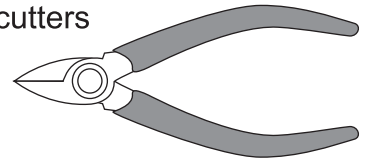

### Long nose pliers

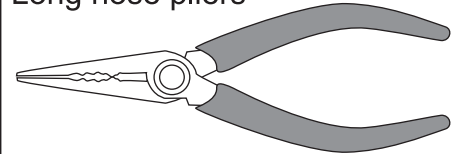

### Hex wrench (1.5mm)

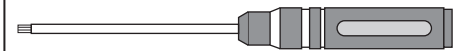

### Hex wrench (2mm)

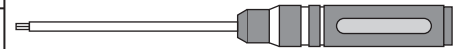

### Tweezers



## GT-300W-V2 CHASSIS SPECIFICATION

Overall Length	:275.3mm	Overall Width Front width	:165mm
Wheelbase length	:200mm		:265-172mm
Weigh Chassis only	:280g		

### Cap

	M3×4	SJG304
	M3×6	SJG306
	M3×8	SJG308
	M3×10	SJG310
	M3×12	SJG312

### Cap screw

	M2×6	SG206
	4#40	SG4#40

### Grub screw

	M3×3	SK303
	M3×8	SK308
	M3×10	SK310

### Lock nut

	M3	SN-M3
	M3	SN-M3F

### E-Ring

	E-Ring 2.0	OE-E2.0
	E-Ring 1.5	OE-E1.5

### Screw

	M2×4	SIG204
	M2.5×4	SIG2.54
	M3×6	SIG306
	M3×8	SIG308
	M3×10	SIG310

### Ball bearing

	∅3.175×∅7.938×2.779	FR2-5ZZ
	∅6.35×∅9.525×3.175	R168-2RS
	∅6.35×∅9.525×3.175	FR168-ZZ



① ~ ④  
Kit Bag A



TS0102010 .....2



SJG\_M3X4 .....2

1

Lower deck

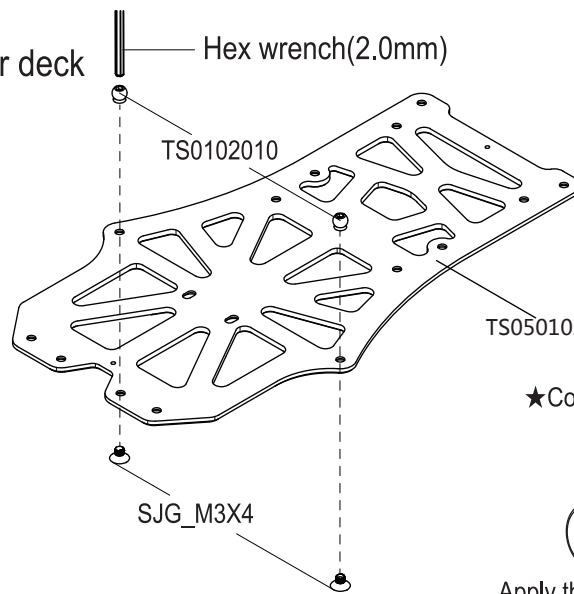

★ Countersunk hole on the bottom.

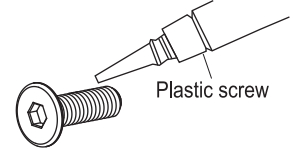

Apply thread lock to the sections shown by this mark.



TS0102010 .....3



SJG\_M3X6 .....1



SJG\_M3X4 .....2



SG\_M2X6 .....2

2

Lower brace

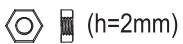
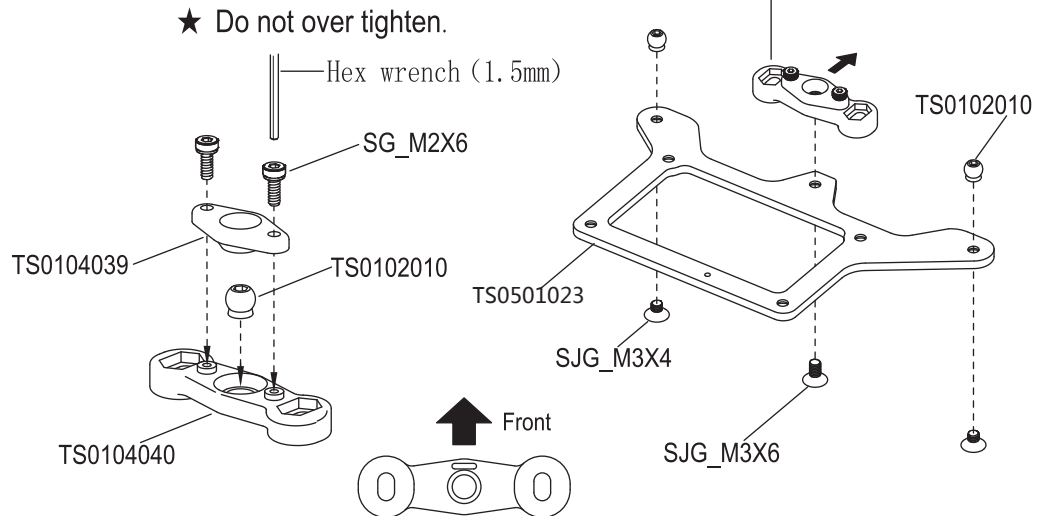

TS0201031 .....2



SJG\_M3X8 .....2

3

Attaching lower brace

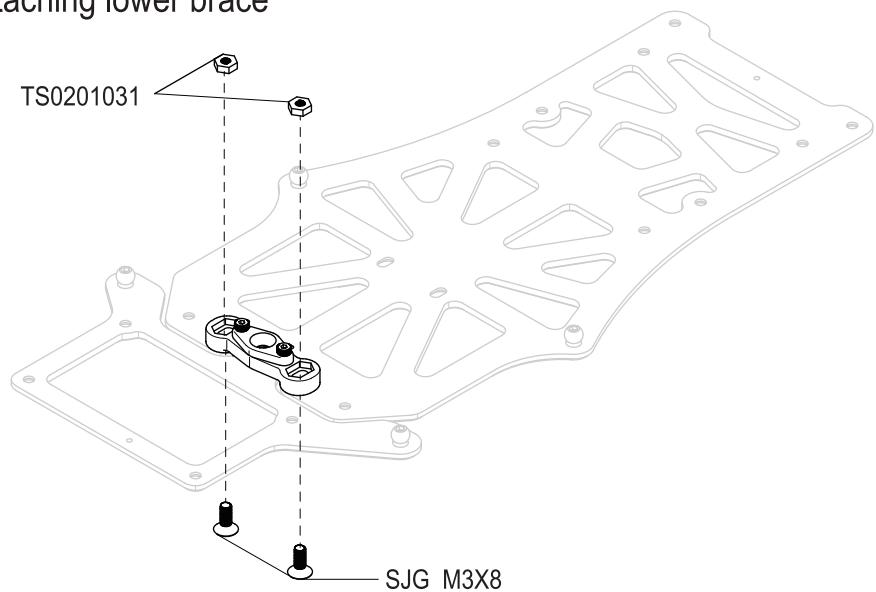



TS0104038 .....2



SG\_M2X6 .....4

4

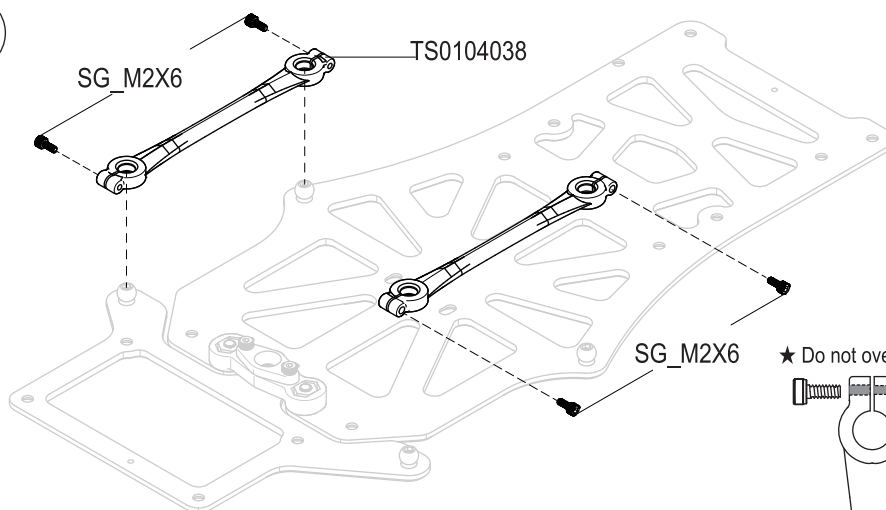

★ Do not over tighten.

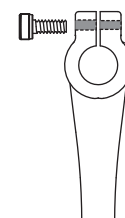

★ Note direction



5

Kit Bag B

★ Assemble on a flat surface to prevent distortion.

5

Motor mount

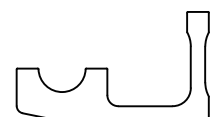

TS0501028 .....1

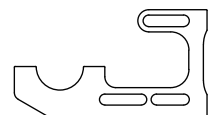

TS0501029 .....1



SIG\_M3X10 .....2



SJG\_M3X6 .....4

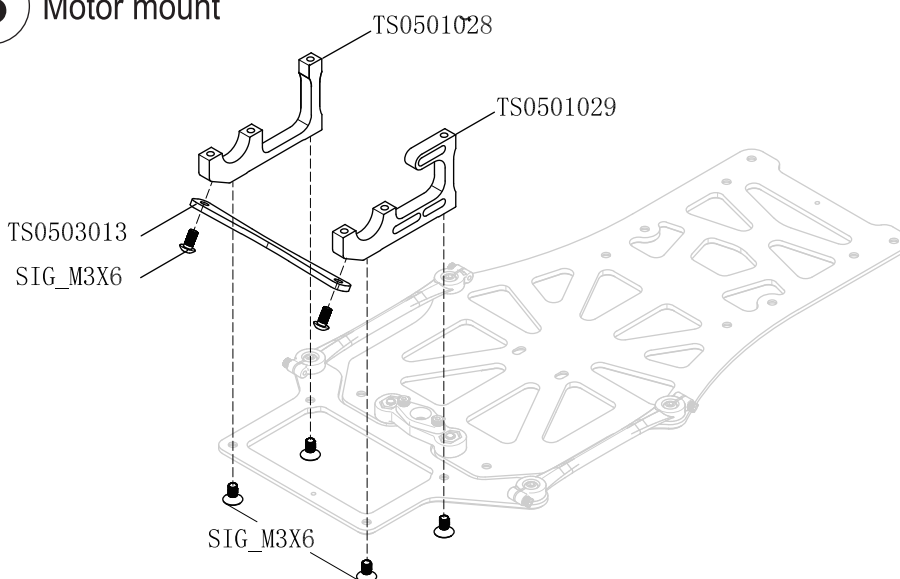

6 ~ 7

Kit Bag C

6

Attaching rear shaft

◎ I (ø3.0xø2.0x0.5)

TS0501020 .....8

◎ I (ø6.4xø8.4x1.0)

TS0501017 .....2

◎ I (ø6.35xø9.525x3.175)

R168-2RS .....2



SG\_M3X8 .....1



SG\_4#40 .....1

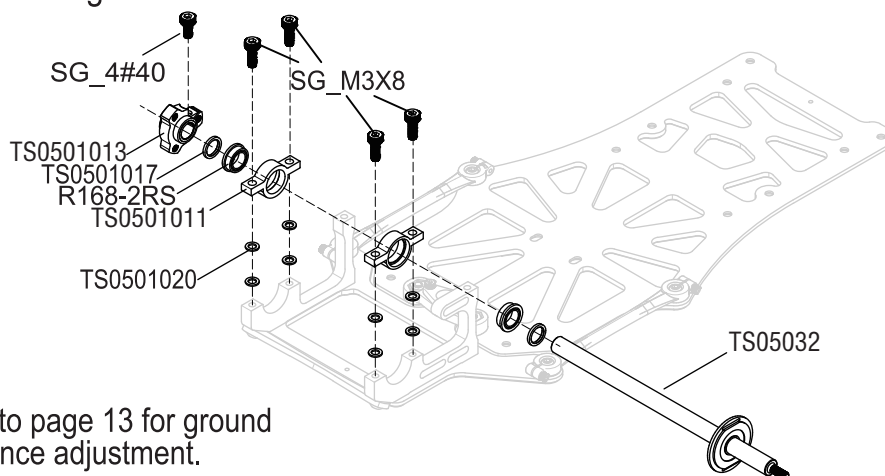

★ Refer to page 13 for ground clearance adjustment.

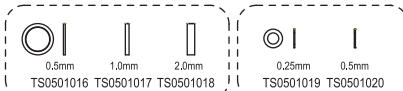

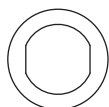

TS0102004.....2



TS0501021.....1



FR168ZZ.....2



R168-2RS.....1



TS0102034.....4

○ (1/8mm)

TS0508007.....12



SN\_M3\_F.....1

## 7 Ball differential

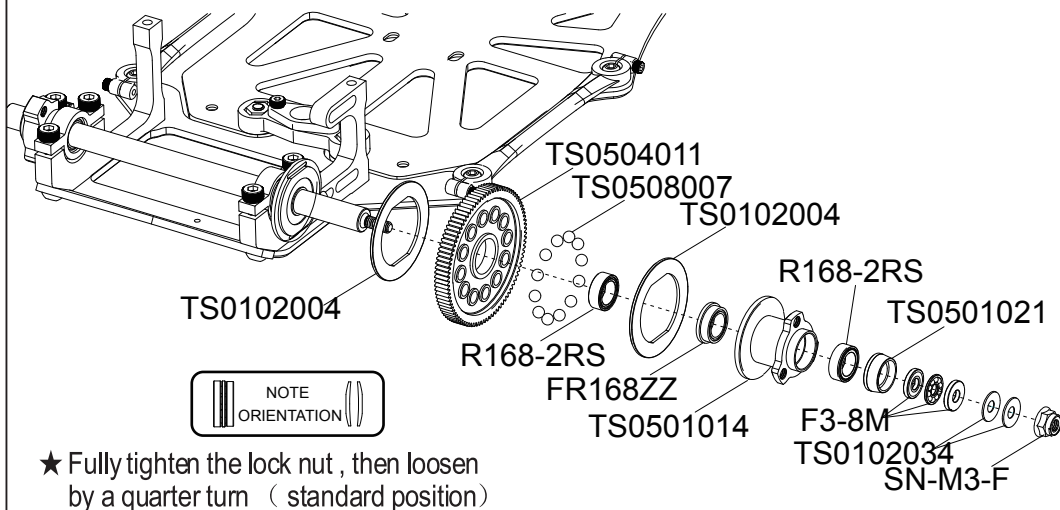

8 ~ 12

Kit Bag D



TS0104042.....2



TS0102001.....2



TS0101007.....2



SIG\_M3X6.....2



SK\_M3X8.....2

## 8 Body mount plate

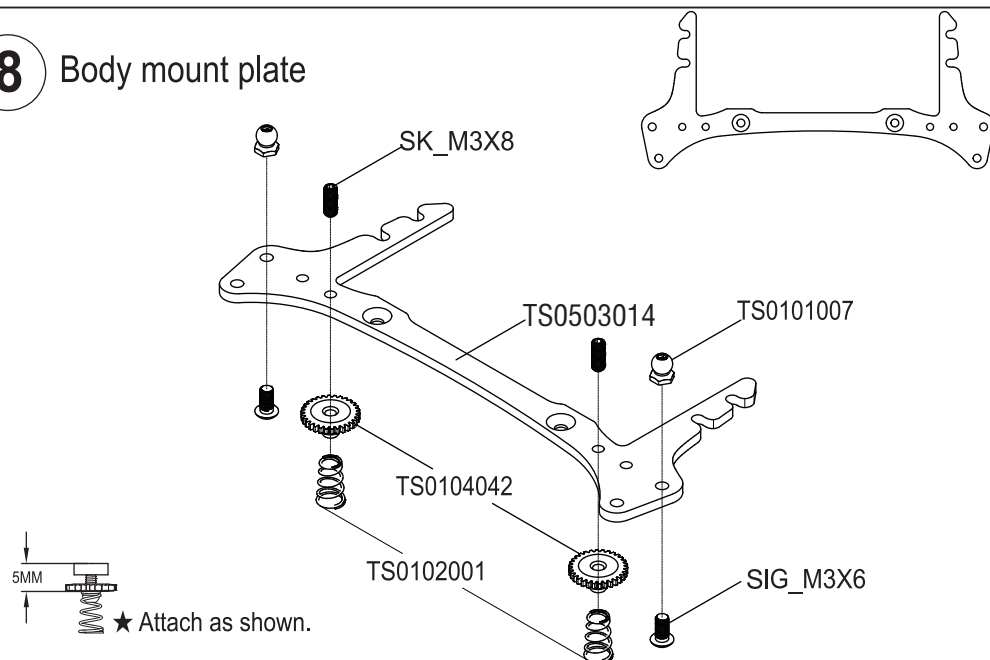

(h=15mm)

TS0201026.....2



SJG\_M3X6.....4

## 9

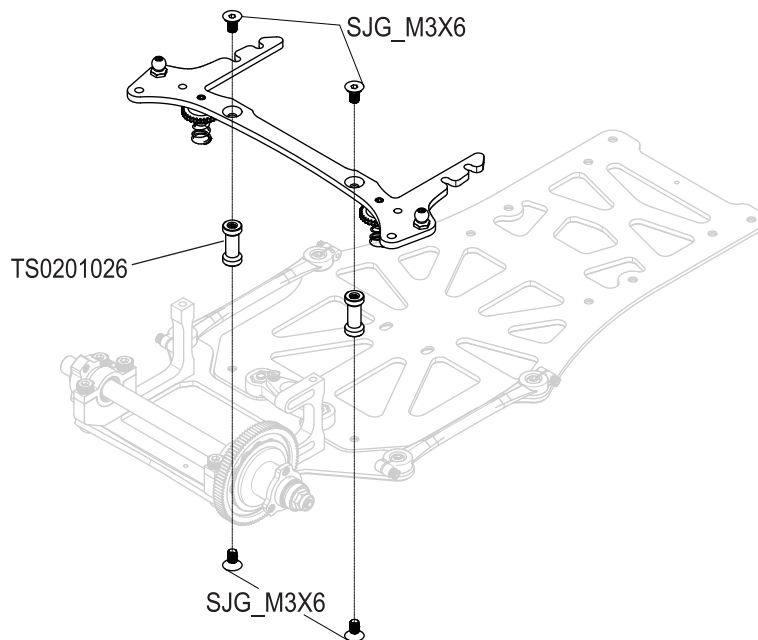

<div data-bbox="135 97 167 129" data-label="Image"></div> <div data-bbox="124 133 391 168" data-label="Text">TS0101007.....3</div> <div data-bbox="127 189 178 222" data-label="Image"></div> <div data-bbox="124 230 391 265" data-label="Text">SJG_M3X6.....2</div> <div data-bbox="127 286 167 319" data-label="Image"></div> <div data-bbox="124 334 391 368" data-label="Text">SJG_M3X6.....1</div>	<div data-bbox="446 86 523 168" data-label="Text">10</div> <div data-bbox="694 118 1300 657" data-label="Image"> </div>
<div data-bbox="135 758 338 793" data-label="Image"></div> <div data-bbox="124 802 391 836" data-label="Text">TS0104026.....4</div> <div data-bbox="127 858 274 890" data-label="Image"></div> <div data-bbox="124 903 391 937" data-label="Text">TS0101018.....2</div> <div data-bbox="127 959 252 991" data-label="Image"></div> <div data-bbox="124 1000 391 1034" data-label="Text">TS0104080.....2</div> <div data-bbox="127 1056 178 1088" data-label="Image"></div> <div data-bbox="124 1082 391 1116" data-label="Text">SK_M3X10 .....2</div>	<div data-bbox="446 750 523 832" data-label="Text">11</div> <div data-bbox="837 750 1292 819" data-label="Text"> <p>★ Apply different viscosities of grease to the piston to adjust roll damper hardness.</p> </div> <div data-bbox="470 786 1484 1358" data-label="Image"> </div>
<div data-bbox="127 1422 178 1455" data-label="Image"></div> <div data-bbox="124 1466 391 1500" data-label="Text">SIG_M3X6.....2</div>	<div data-bbox="446 1412 523 1494" data-label="Text">12</div> <div data-bbox="614 1412 1364 2026" data-label="Image"> </div>



13 ~ 19  
Kit Bag E

- TS0101007.....2
- TS0202001.....2
- ⊙ □ (L=2.5mm)
- TS0101029.....2
- SIG\_M3X8.....2
- SIG\_M2.5X4.....2

### 13 Attaching front uprights

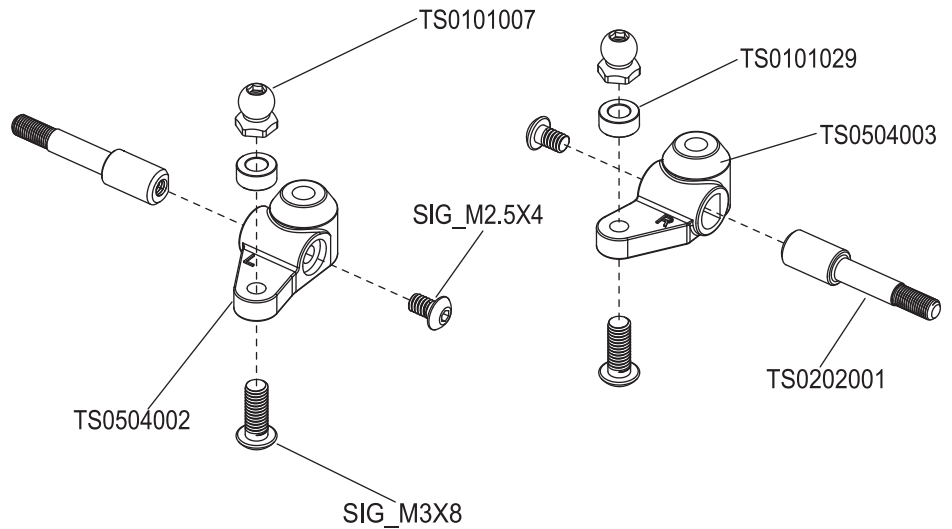

- TS0204004.....2
- TS0204002.....2
- TS0202003.....2
- TS0204005.....2



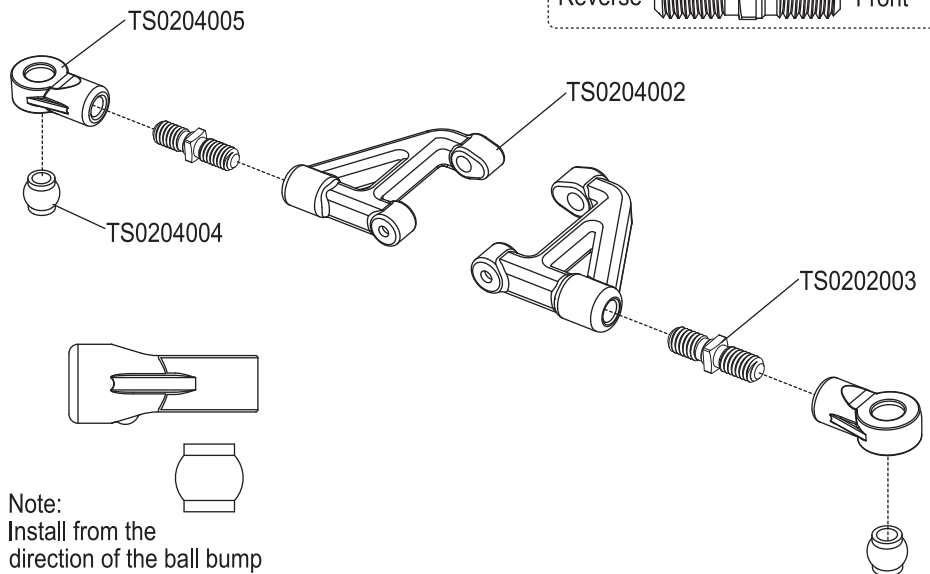



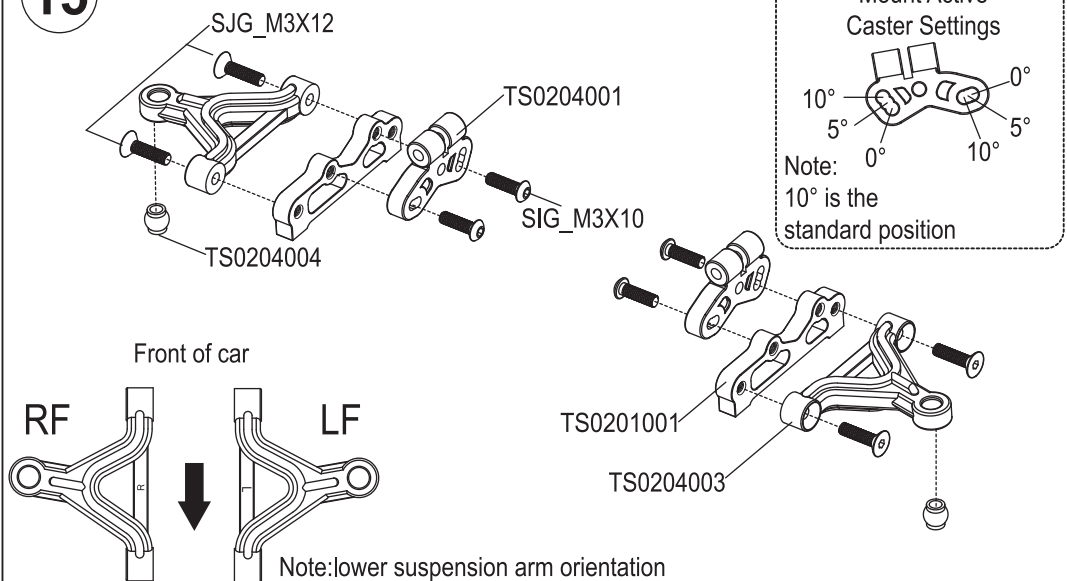

### 14

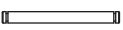
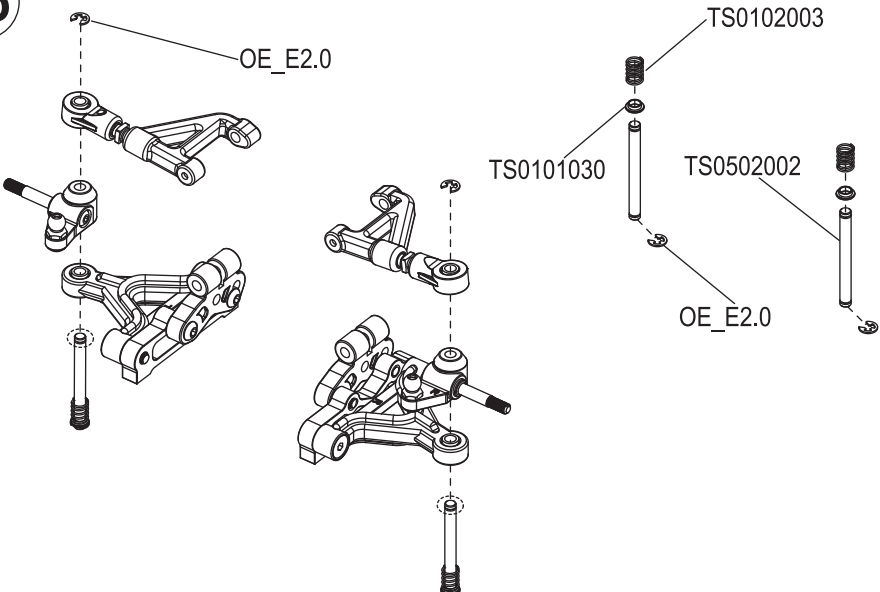
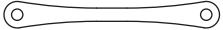

- TS0201001.....2
- TS0204001.....2
- SJG\_M3X12.....4
- SIG\_M3X10.....4
- TS0204004.....2

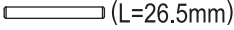
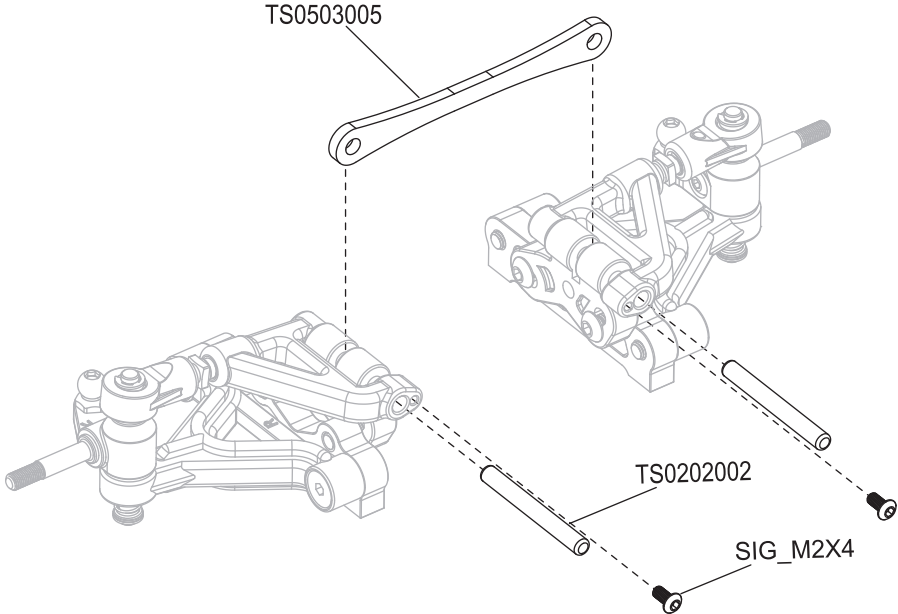
### 15

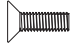
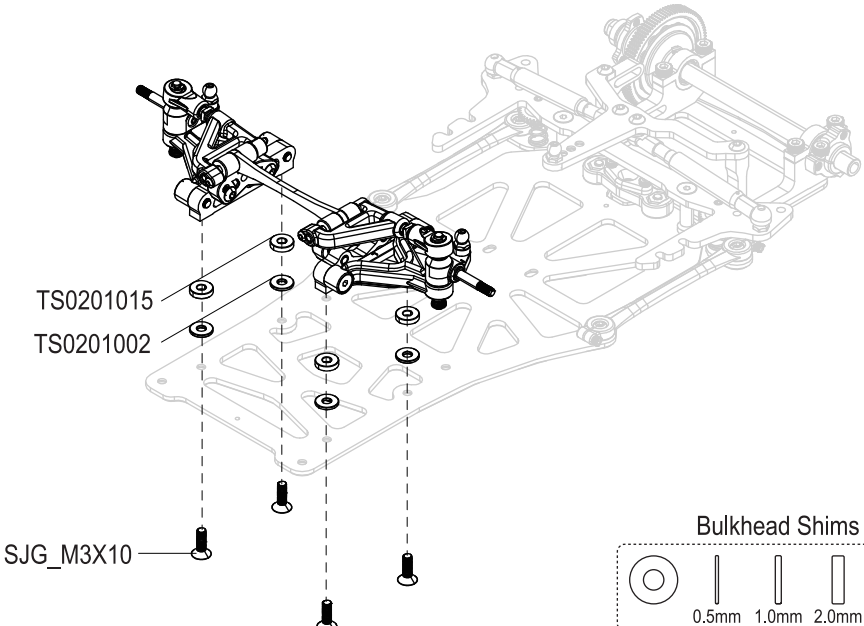
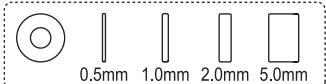

<div>  <p>OE_E2.0.....4</p> </div> <div>  <p>TS0101030 .....2</p> </div> <div>  <p>TS0102003 .....2</p> </div> <div>  (L=29mm) <p>TS0502002 .....2</p> </div>	<div> <div>16</div>  </div>
<div>  <p>TS0503005 .....1</p> </div> <div>  <p>SIG_M2X4 .....2</p> </div> <div>  (L=26.5mm) <p>TS0202002 .....2</p> </div>	<div> <div>17</div>  </div>
<div>  (ø3.1xø8.0x5.0) <p>TS0201025 .....4</p> </div> <div>  (ø3.1xø8.0x2.0) <p>TS0201015 .....4</p> </div> <div>  (ø3.1xø8.0x1.0) <p>TS0201002 .....4</p> </div> <div>  (ø3.1xø8.0x0.5) <p>TS0201014 .....4</p> </div> <div>  <p>SJG_M3X10 .....4</p> </div>	<div> <div>18</div>  <div> <div>Bulkhead Shims</div>  </div> </div>



TS0204006 .....2



TS0204007 .....2

19

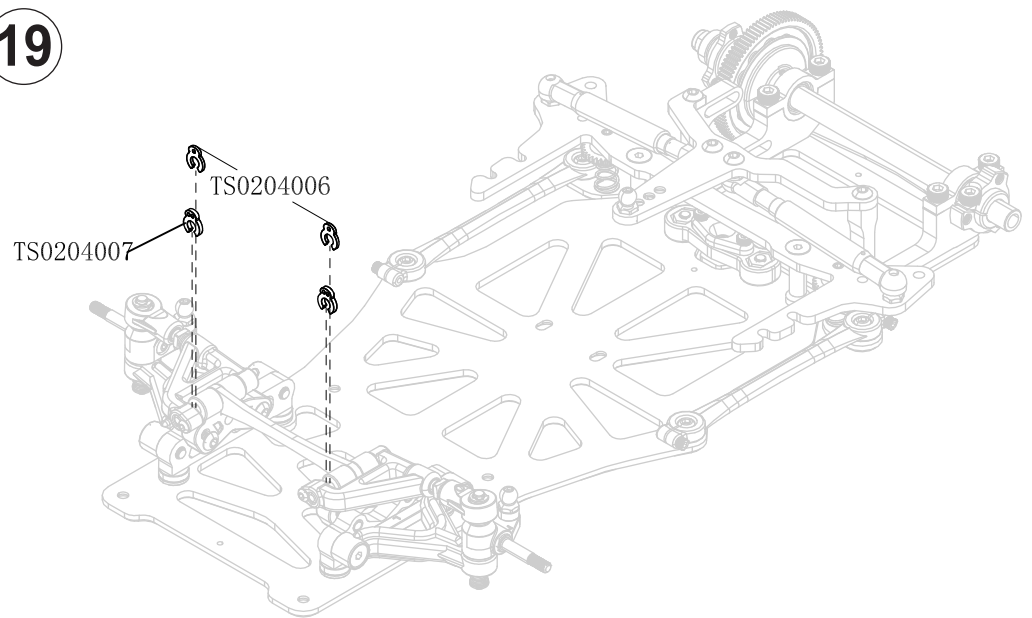

(20 ~ 23)  
Kit Bag F

20

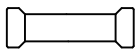

TS0101053 .....2



SJG\_M3X6 .....2

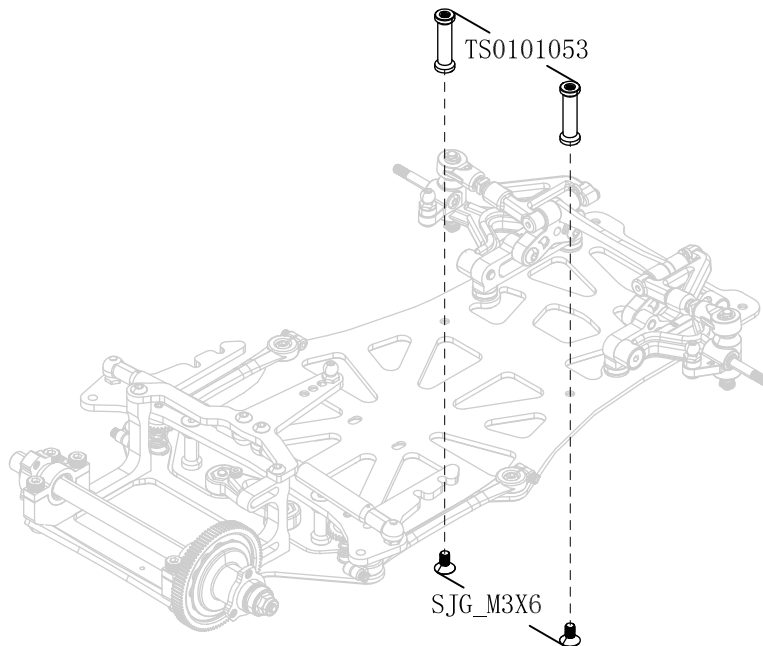

TS0501025 .....2



TS0101007 .....2



TS0102017 .....1



TS0102016 .....2



SIG\_M3X6 .....6



SIG\_M3X10 .....1

21

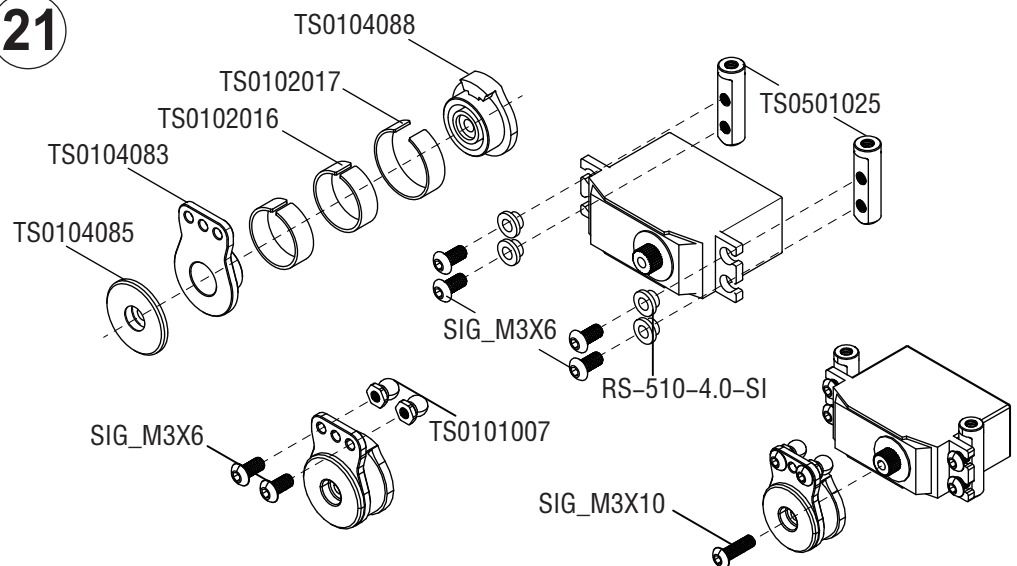



24 ~ 28  
Kit Bag G

TS0101007 .....1  
SIG\_M3X6 .....3

22

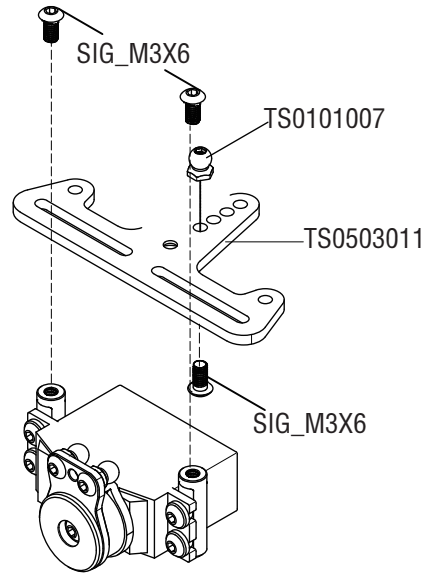

SIG\_M3X8 .....2

23

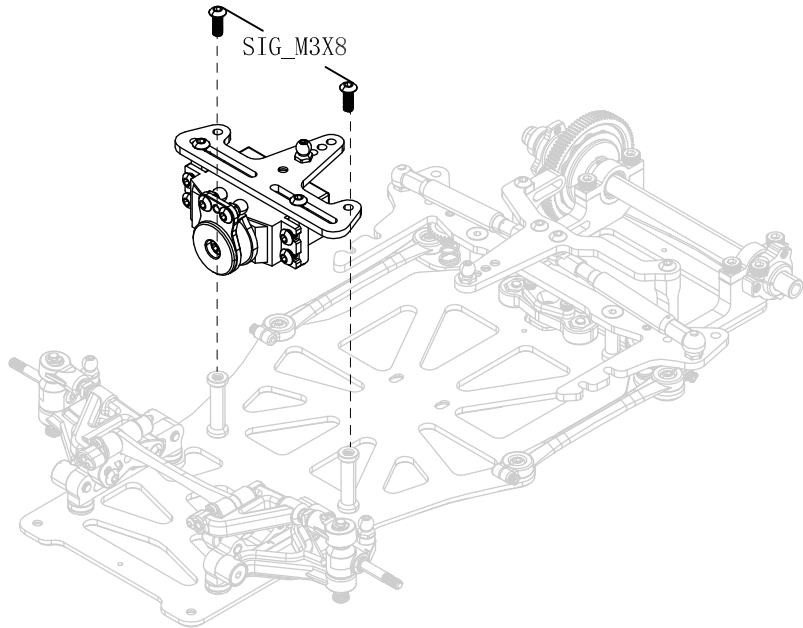

TS0501008 (L=43mm) .....2  
TS0104027 (L=18.5mm) .....4

24 Servo saver

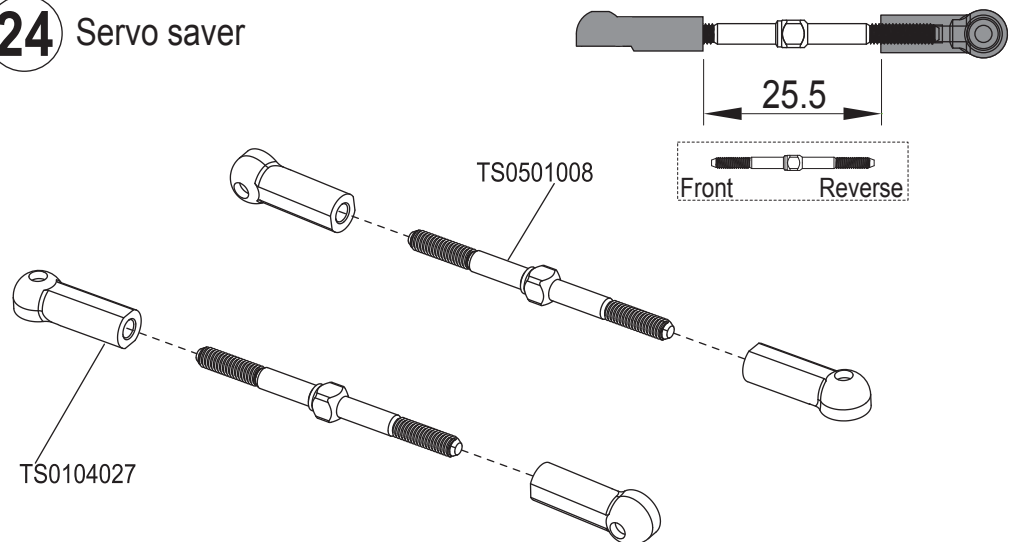

25

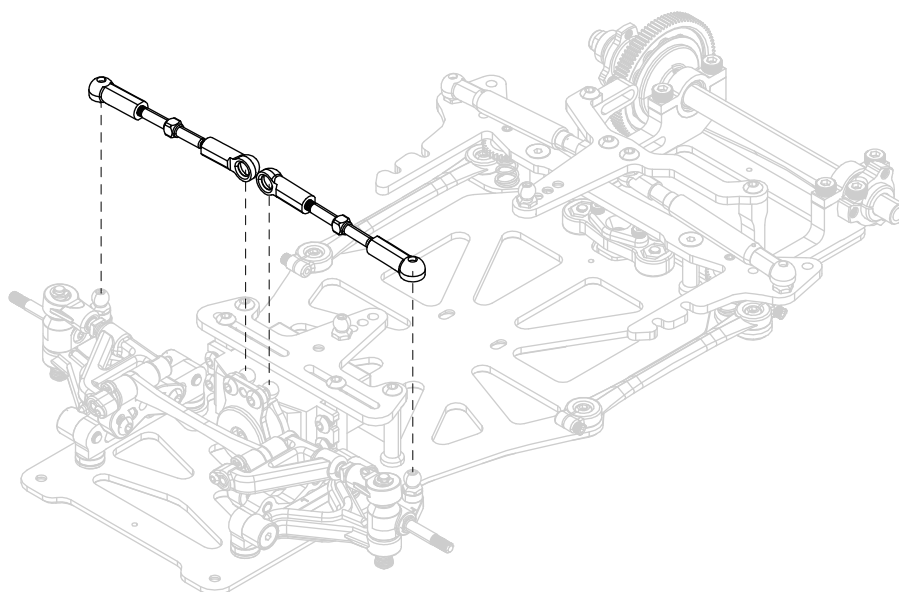

22 ~ 28  
Kit Bag G

— (L=22mm)

TS0502001.....1

⊙ (ø2Xø6X2.0)

TS0505002.....1

○ (ø6Xø8X1.0)

TS0505003.....1

○ (ø10Xø12X1.0)

TS0505001.....1

⊙

TS0502005.....1

⊙

OE\_E1.5.....2

## 26 Damper assembly

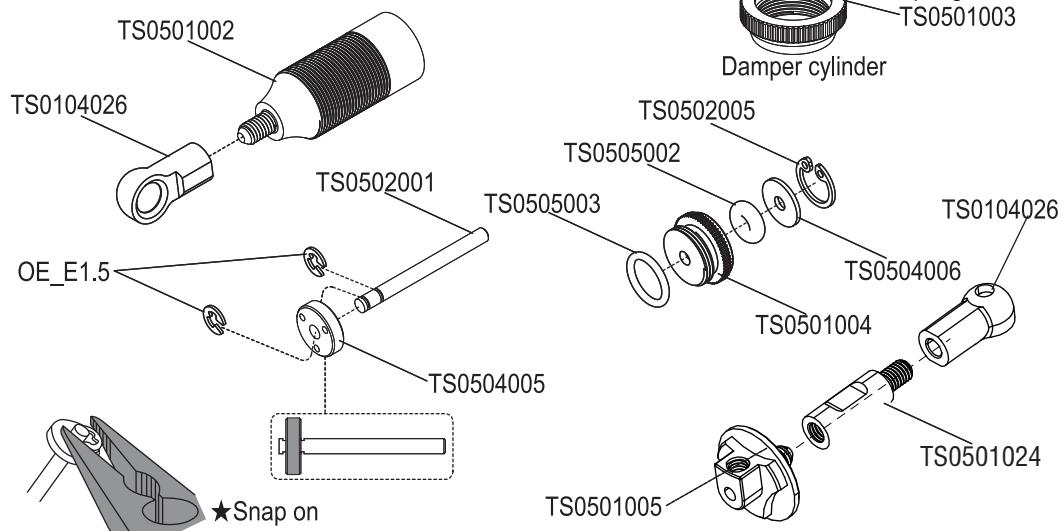

## 27 Dampers oil

1. Pull up piston and pour oil into cylinder. Remove air bubbles by slowly moving piston up and down.

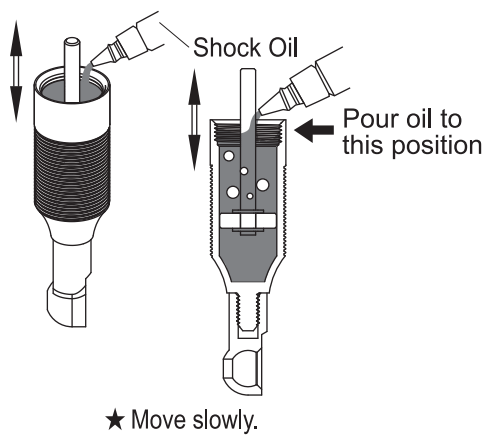

2. Pull up piston, attach oil seal and absorb oil overflow with tissue paper.

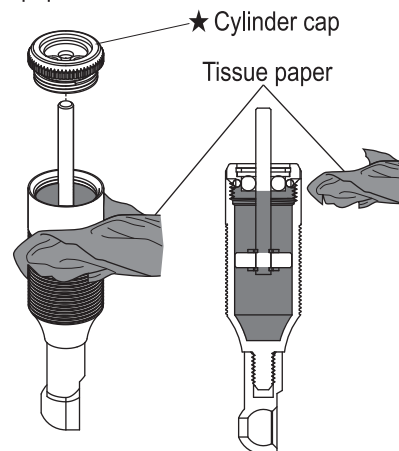



TS0502003.....1



SK\_M3X3.....1

## 28 Attaching dampers

★ Select damper spring according to running surface condition.

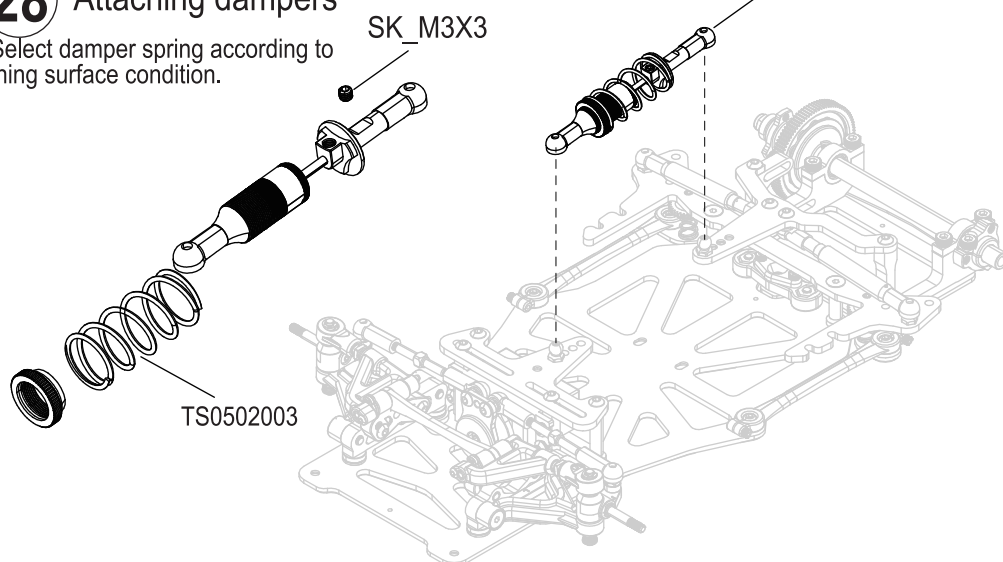

(29 ~ 35)  
Kit Bag H



TS0104006.....2



TS0504001.....2



SJG\_M3X10.....2

## 29

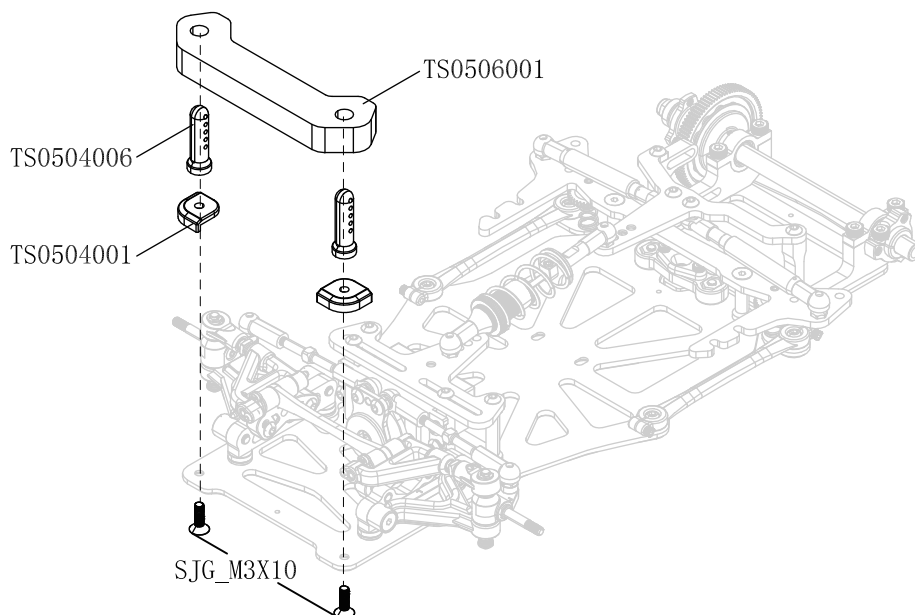

## 30



TS-P034\_R6.....4



TS0104003.....2

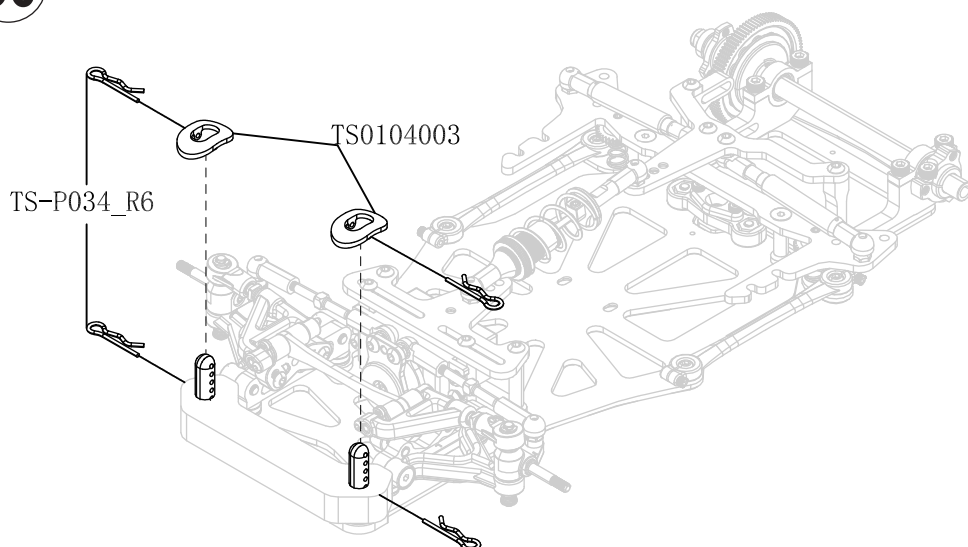



TS-P034\_R6.....2



TS0104003.....2



TS0104010.....2



SIG\_M3X8.....2

**31**

★ Adjust snap pin positions according to the body.

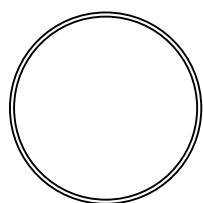
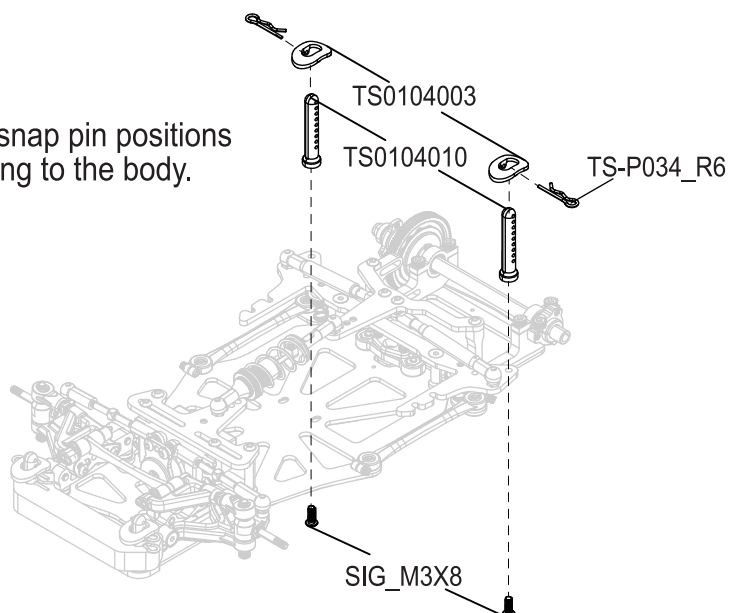

TS0505001.....1

**32**

Battery assemble position

★ According to the back groove of chassis bind the battery with tape.

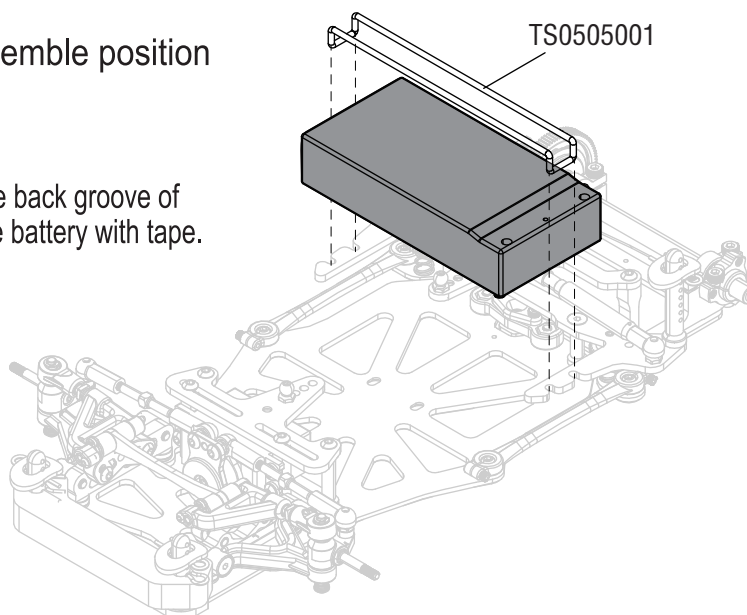

TS0201007.....1



SJG\_M3X4.....2

**33**

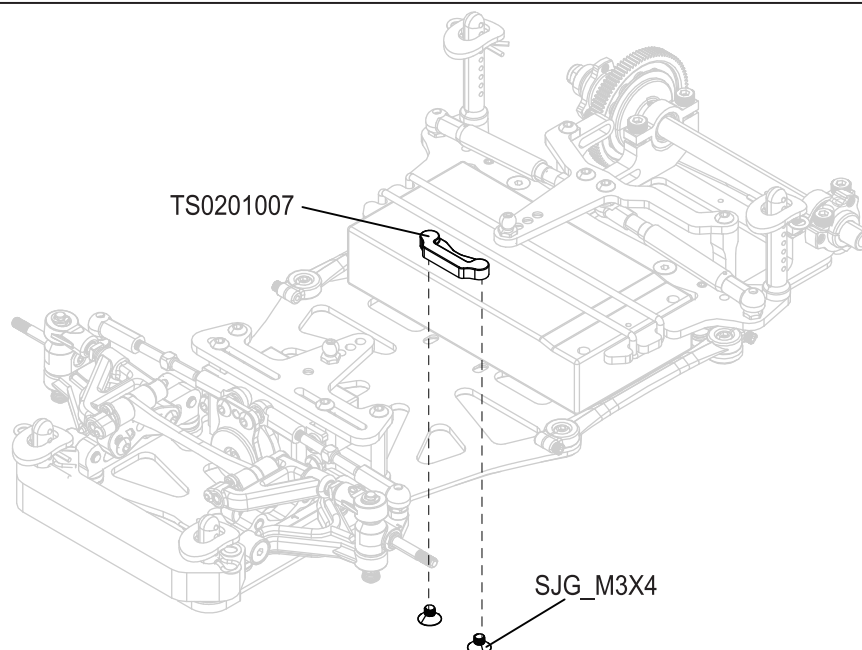

★ Tighten up into nylon portion.

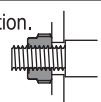

## 34 Attaching wheels

○ (ø3.175Xø7.938X2.779)

FR2-5ZZ.....4



SN\_M3.....2

○ (ø4.7Xø3.2X0.4)

TS0202005.....2

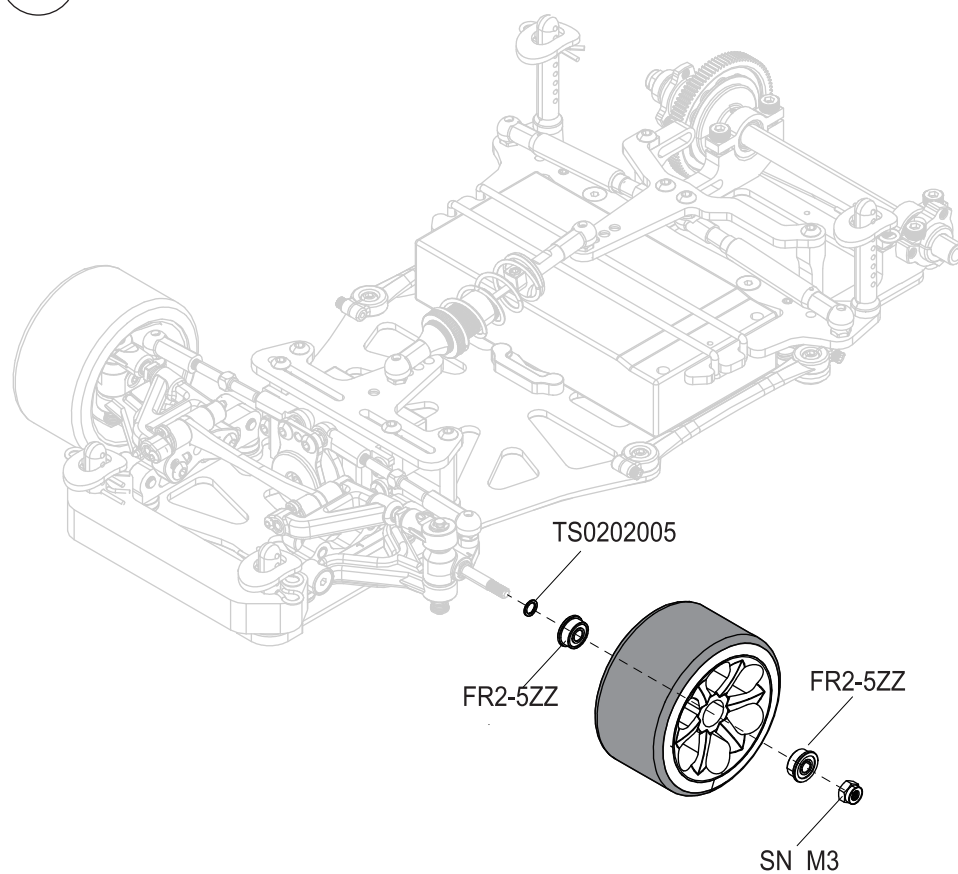

## 35



SG\_4#40.....6



SK\_M3X3.....1



SIG\_M3X8.....3

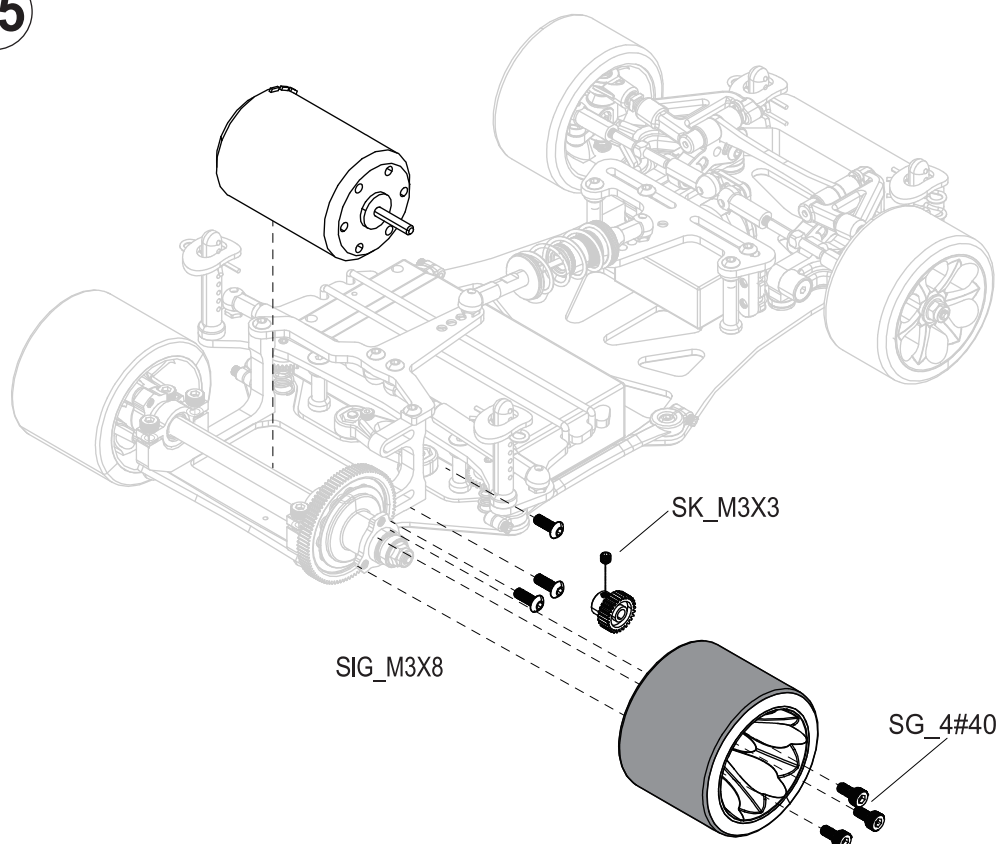

# SETTING - UP

- Record various running conditions and settings on the setting sheet on page 13.

## TOE-IN AND TOE-OUT

Toe-in and toe-out

★Adjust rod length by rotating adjuster.

★Make sure the servo is in neutral.

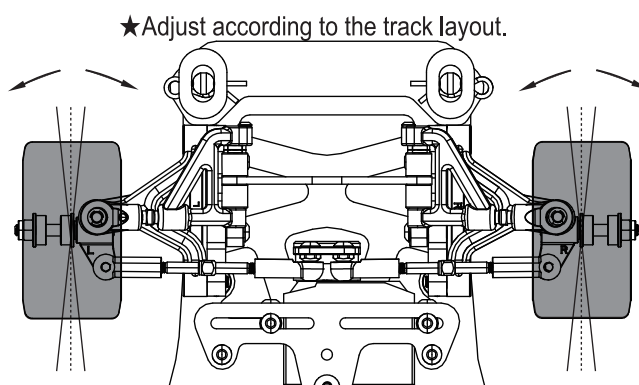
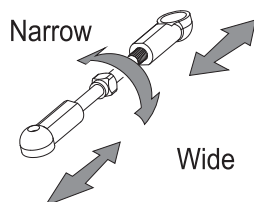

## CAMBER ANGLE

Camber angle



★Adapt for the draw bar to adjust camber angle.

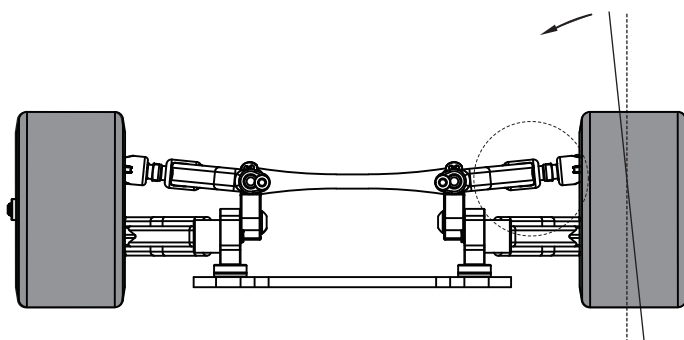
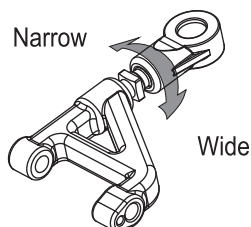

## GROUND CLEARANCE

Front

★Ways for adjusting the turnbuckle to fit the hardness of the front suspension.

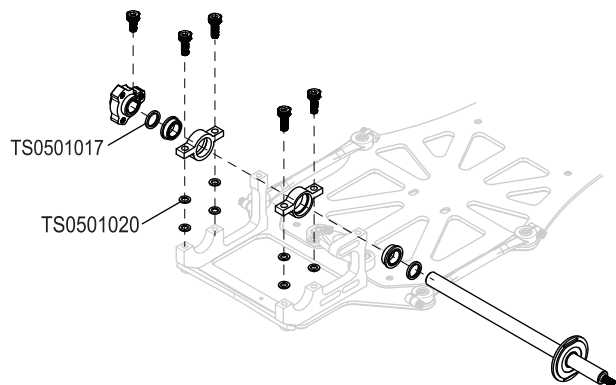
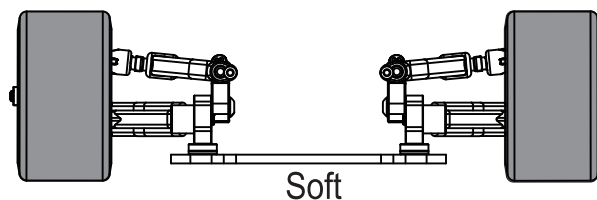
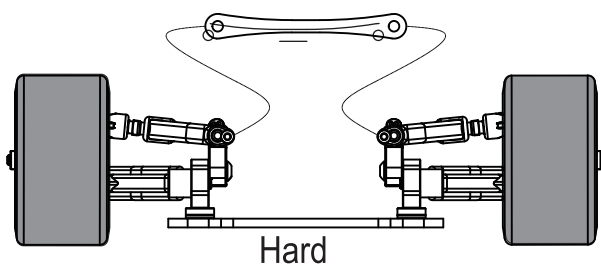

★Use different washers to adjust the height and width of rear axle.

**NOTE:**

**VAPON INDUSTRIAL CO., LTD**  
***[Http://www.saxoracing.com](http://www.saxoracing.com)***  
***[E-mail:saxo@saxoracing.com](mailto:saxo@saxoracing.com)***



**GT-300W-V3**

